

CROSS SECTION

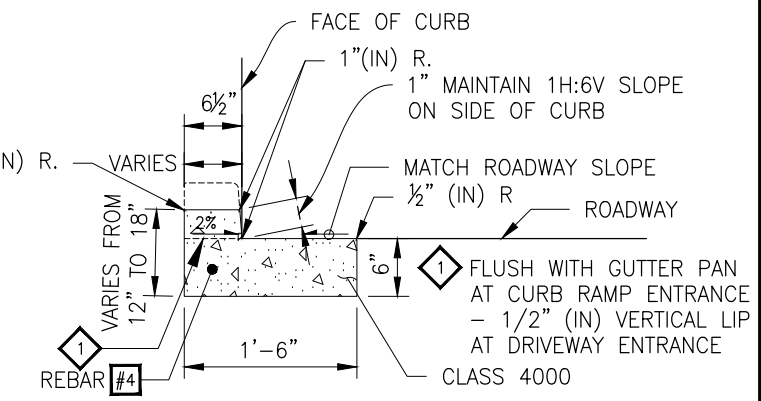

DEPRESSED CURB SECTION

AT CURB RAMPS AND DRIVEWAY ENTRANCES

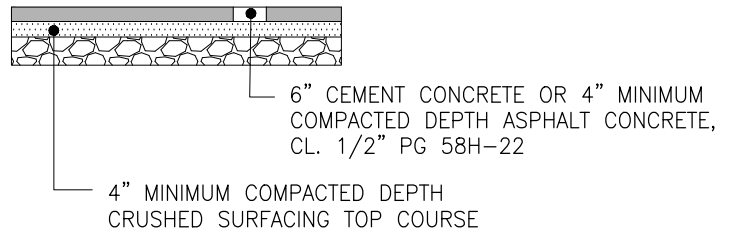

DRIVEWAY CROSS SECTION WITHIN RIGHT-OF-WAY

NOT TO SCALE

NOTES:

1. DRIVEWAY FOR COMMERCIAL USE ONLY. REQUIRES PUBLIC WORKS DIRECTOR APPROVAL.
2. DRIVEWAY WIDTH = 24' MINIMUM TO 35' MAXIMUM.
3. DRIVEWAY PAVING = 6" MINIMUM CEMENT CONCRETE OR: 4" MINIMUM COMPACTED DEPTH ASPHALT CONCRETE PAVEMENT CL. 1/2" PG 58H-22, OVER 4" MINIMUM COMPACTED DEPTH CRUSHED SURFACING TOP COURSE. BETWEEN SIDEWALK AND RIGHT OF WAY LINE CAN BE CEMENT CONCRETE IF THE EXISTING DRIVEWAY IS CEMENT CONCRETE.
4. STORM DRAINAGE FROM DRIVEWAY SHALL NOT BE PERMITTED TO DRAIN ONTO ROADWAY SURFACE, UNLESS ACCOUNTED FOR IN DESIGN, AND APPROVED UNDER A DEVIATION REQUEST.
5. DRIVEWAY SHALL NORMALLY BE AT 90 DEGREES TO ROAD CENTERLINE, BUT CAN VARY FROM 75 DEGREES TO 105 DEGREES.
6. A VERTICAL CURVE SHALL BE CONSTRUCTED TO TRANSITION THE LANDING TO THE ACCESS APPROACH. THE VERTICAL SEPARATION BETWEEN THE CURVE AND A 10-FOOT CHORD OF THE CURVE SHALL NOT EXCEED 3.25 INCHES (WHERE D IS POSITIVE) OR 2.00 INCHES (WHERE D IS NEGATIVE).
7. FORM AND SUBGRADE INSPECTION REQUIRED BEFORE PAVING.
8. ON SITE STORM DRAINAGE REQUIRED.
9. WHEN ROADWAY PROFILE GRADE EXCEEDS 4%, ADJUST RAMP LENGTHS TO MEET AMERICANS WITH DISABILITIES ACT REQUIREMENTS.
10. MUST PROVIDE ADA CROSSING AT DRIVEWAY.



CITY OF DES MOINES
PUBLIC WORKS DEPARTMENT
 ENGINEERING SERVICES
 21650 11TH AVENUE SOUTH
 DES MOINES, IA 50319



MAJOR DRIVEWAY W/ RADIUS RETURN

DM.C3.4

REVISED: 02/23